

## VERLENGSTUK BUITENDR.-BINNENDR RACCORDS À FILETAGE CONIQUE / ALLONGEMENT

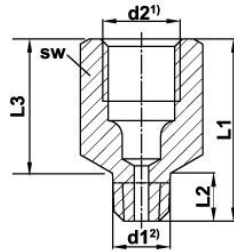

| Artikelnummer / Référence    | Fig. | d1        | d2         | L1   | L2   | L3 | sw | tuyau Ø |
|------------------------------|------|-----------|------------|------|------|----|----|---------|
| FI.526.M6-M8X1-18            | 1    | M 6 x 1   | M 8 x 1    | 18   | 8    | 10 | 11 | 4       |
| FI.526.M8X1-M8X1-18          | 1    | M 8 x 1   | M 8 x 1    | 18   | 8    | 10 | 11 | 4       |
| FI.526.M8X1-M8X1-32          | 1    | M 8 x 1   | M 8 x 1    | 32   | 22   | 10 | 11 | 4       |
| FI.526.M8X1-M8X1-62,5        | 1    | M 8 x 1   | M 8 x 1    | 62,5 | 52,5 | 10 | 11 | 4       |
| FI.526.M8X1-M10X1-23         | 2    | M 8 x 1   | M 10 x 1   | 23   | 12   | 11 | 13 | 6       |
| FI.526.M10X1-M8X1-18         | 1    | M10 x 1   | M 8 x 1    | 18   | 8    | 10 | 11 | 4       |
| FI.526.M10X1-M10X1-18        | 2    | M10 x 1   | M 10 x 1   | 18   | 7    | 11 | 13 | 6       |
| FI.526.M10X1-M10X1-23 * inox | 2    | M10 x 1   | M 10 x 1   | 23   | 12   | 11 | 13 | 6       |
| FI.526.M10X1-M10X1-35        | 2    | M10 x 1   | M 10 x 1   | 35   | 24   | 11 | 13 | 6       |
| FI.526.M10X1-M10X1-40        | 2    | M10 x 1   | M 10 x 1   | 40   | 29   | 11 | 13 | 6       |
| FI.526.M10X1-M10X1-50        | 2    | M10 x 1   | M 10 x 1   | 50   | 39   | 11 | 13 | 6       |
| FI.526.R02-M10X1-18          | 2    | R 1/8 BSP | M 10 x 1   | 18   | 7    | 11 | 13 | 6       |
| FI.526.R02-R02-18            | 2    | R 1/8 BSP | Rp 1/8 BSP | 18   | 7    | 11 | 13 | 6       |
| FI.526.R02-M8X1-18           | 2    | R 1/8 BSP | M8 x 1     | 18   | 7    | 11 | 13 | 4       |
| FI.526.R02-R02-23 * inox     | 2    | R 1/8 BSP | Rp 1/8 BSP | 23   | 12   | 11 | 13 | 6       |
| FI.526.R02-R02-30            |      | R 1/8 BSP | Rp 1/8 BSP | 30   | 18   | 12 | 13 |         |
| FI.526.R02-R02-35            | 2    | R 1/8 BSP | Rp 1/8 BSP | 35   | 23   | 12 | 13 | 6       |
| FI.526.R02-R02-41            |      | R 1/8 BSP | Rp 1/8 BSP | 41   | 29   | 12 | 13 |         |
| FI.526.R02-R02-45            |      | R 1/8 BSP | Rp 1/8 BSP | 45   | 33   | 12 | 13 |         |
| FI.526.R02-R02-50            | 2    | R 1/8 BSP | Rp 1/8 BSP | 50   | 38   | 12 | 13 | 6       |
| FI.526.R02-R04-22            |      | R 1/8 BSP | Rp 1/4 BSP | 22   | 8    | 14 | 17 |         |
| FI.526-R04-M10X1-20          | 2    | R 1/4 BSP | M 10 x 1   | 20   | 9    | 11 | 17 | 6       |
| FI.526-R04-R02-20            | 2    | R 1/4 BSP | Rp 1/8 BSP | 20   | 9    | 11 | 17 | 6       |
| FI.526.R04-R06-27            |      | R 1/4 BSP | Rp 3/8 BSP | 27   | 11   | 16 | 22 |         |
| FI.526.R04-R04-25            |      | R 1/4 BSP | Rp 1/4 BSP | 25   | 17   | 8  | 17 |         |



|                         |  |            |            |    |    |    |     |  |
|-------------------------|--|------------|------------|----|----|----|-----|--|
| FI.526.R04-R04-85       |  | R 1/4 BSP  | Rp 1/4 BSP | 85 | 71 | 14 | 17  |  |
| FI.526.R02NPT-R02NPT-20 |  | 1/8 NPT    | 1/8 NPT    | 20 | 9  | 11 | 1/2 |  |
| FI.526.R02NPT-R02NPT-30 |  | 1/8 NPT    | 1/8 NPT    | 30 | 18 | 12 | 1/2 |  |
| FI.526.R04UNF-R02-23    |  | 1/4-28 UNF | 1/8 BSP    | 23 | 12 | 11 | 1/2 |  |

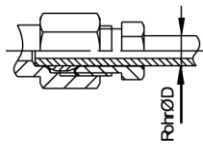

**fig. 1**

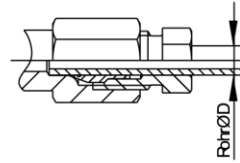

**fig. 2**

\* inox